

# Schoudered Coupling

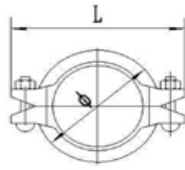

Normal Size mm-inch	Pipe O.D. mm-inch	Working Pressure Bar/PSI	Bolt Size No-Size in mm	Dimension in mm		
				∅	length	height
50-2"	60,3-2.375"	34,5/500	2-M12x60	97-3.957"	132-5.197"	48-1.890"
80-3"	88,9-3.500"	34,5/500	2-M12x75	125-4.921"	170-6.692"	48-1.890"
100-4"	114,3-4.500"	34,5/500	2-M12x75	157-6.181"	205-8.070"	52-2.047"
150-6"	165,1-6.500"	34,5/500	2-M16x85	213-8.386"	272-10.708"	52-2.047"
200-8"	219,1-8.625"	34,5/500	2-M20x100	278-10.945"	345-13.583"	60-2.362"
250-10"	273,0-10.748"	34,5/500	2-M22x130	340-13.380"	415-16.339"	64-2.520"
300-12"	323,9-12.752"	34,5/500	2-M22x130	387-15.236"	474-18.661"	64-2.520"
350-14"	377,0-14.843"	34,5/500	2-M22x130	438-17.244"	518-20.394"	76-2.992"
400-16"	425,5-16.752"	34,5/500	2-M30x140	506-19.921"	605-23.819"	76-2.992"