

Flexible Coupling

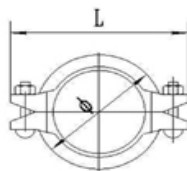

Normal Size mm-inch	Pipe O.D. mm-inch	Working Pressure Bar/PSI	Bolt Size No-Size in mm	Dimension in mm		
				∅	length	height
25-1"	33,7-1.327"	34,5/500	2-M10x45	60-2,362"	98-3.858"	43.5-1.713"
32 - 1¼"	42,4-1.669"	34,5/500	2-M10x45	67-2.638"	106-4.173"	44-1.732"
40-1½"	48,3-1.900"	34,5/500	2-M10x45	73-2.874"	108-4.252"	44-1.732"
50-2"	57,0-2.245"	34,5/500	2-M10x55	83-3.268"	122-4.803"	45-1.772"
50-2"	60,3-2.375"	34,5/500	2-M10x55	87-3.425"	123-4.843"	44-1.732"
65-2½"	73,0-2.875"	34,5/500	2-M10x55	100-3.937"	138-5.433"	44-1.732"
65-2½"	76,1-3.000"	34,5/500	2-M10x55	103-4.055"	142-5.591"	45-1.772"
80-3"	88,9-3.500"	34,5/500	2-M12x60	117-4.606"	166-6.535"	45-1.772"
100-4"	108,0-4.250"	34,5/500	2-M12x65	137-5.393"	188-7,401"	48-1.889"
100-4"	114,3-4.500"	34,5/500	2-M12x65	139-5,472"	190-7,480"	49-1,929"
125-5"	133-5.250"	27,5/400	2-M12x75	163-6,417"	210-8,268"	49-1,929"
125-5"	139,7-5.500"	27,5/400	2-M12x75	168-6,614"	218-8,583"	49-1,929"
150-6"	159,0-6.250"	27,5/400	2-M12x75	190-7.480"	239-9.409"	49-1,929"
150-6"	165,1-6.500"	27,5/400	2-M12x75	193-7.598"	241-9,488"	49-1,929"
150-6"	168,3-6.625"	27,5/400	2-M12x75	198,5-7.815"	249-9.803"	50-1.969"
200-8"	219,1-8.625"	20,7/300	2-M16x85	253-9.961"	320-12.598"	59-2.323"
250-10"	273,0-10.748"	20,7/300	2-M22x130	317-12.480"	401-15.787"	63-2.480"
300-12"	323,9-12.752"	20,7/300	2-M22x130	375-14.764"	455-17.913"	64-2.520"
350-14"	356,6-14.000"	27,5/400	3-M22x130	418-16.457"	508-20.000"	74-2.913"
350-14"	377,0-14.843"	20,7/300	3-M22x130	441-17.362"	535-21.063"	78-3.071"
400-16"	406,4-16,000"	20,7/300	3-M22x130	467-18.386"	567-22.323"	78-3.071"
400-16"	425,5-16.752"	20,7/300	2-M22x130	486-19.134"	580-22.835"	78-3.071"